

LTR	REVISION	DATE	APPD
-	RELEASED	09-13-16	

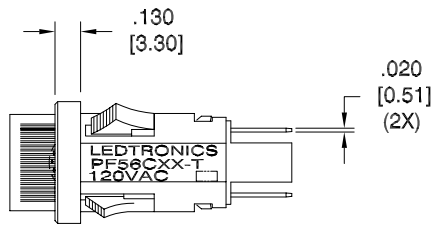

TOP VIEW

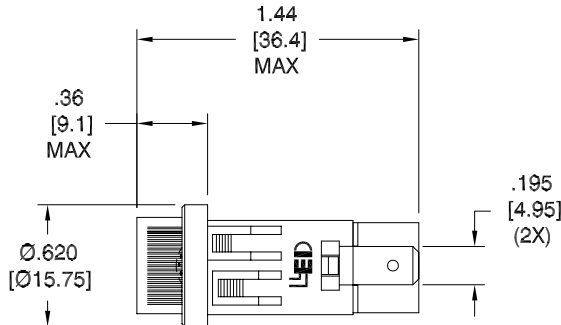

SIDE VIEW

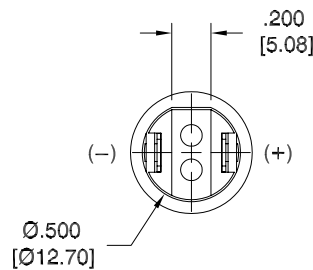

REAR VIEW



NOTES:

1. ALL DIMENSIONS ARE IN INCHES [MILLIMETERS].
2. MOUNTING DIAMETER: Ø1/2" (12.7mm)
3. LENS MATERIAL: POLYCARBONATE (PC) (UL 94V-2)
4. SLEEVE MATERIAL: BLACK, NYLON 66 (UL94V-1 MIN / UL94V-0 PREF)
5. HEADER MATERIAL: BLACK, NYLON 66 (UL94V-1 MIN / UL94V-0 PREF)
6. TERMINAL MATERIAL: BRASS S.A.E. CA 360, FEDERAL QQ-B-626 ALLOY 360
FINISH: TIN PLATE MIL-T-10727 TYPE I, DULL FINISH, .0001-.00025 THICK.

REVISION NOTIFICATION	
<input type="checkbox"/> DLC	
<input type="checkbox"/> UL/ETL	
<input type="checkbox"/> MADE IN USA	
<input type="checkbox"/> CUSTOMER _____	
<input type="checkbox"/> OTHER	
REDLINE CHECKLIST	
<input type="checkbox"/> REDLINE(YES)	
<input type="checkbox"/> DATE: _____	
<input type="checkbox"/> INITIATED BY: _____	
<input type="checkbox"/> ECR REQUIRED YES <input type="checkbox"/> NO <input type="checkbox"/>	
<input type="checkbox"/> WORK ORDER# _____	

ELECTRICAL-OPTICAL CHARACTERISTICS (Ta=25°C)

PF56CG6-0004	PF56CG6-120VAC/8-B/TI	HI-EFF GREEN	120Vac	0.006-0.008 A	0.038cd	565	160°
PF56CR6-0004	PF56CR6-120VAC/8-B/TI	HI-EFF RED	120Vac	0.006-0.008 A	0.022cd	633	160°
PF56CY6-0001	PF56CY6-120VAC/8-B/TI	YELLOW	120Vac	0.006-0.008 A	0.015cd	585	160°
LEDTRONICS PART NO.	DESCRIPTION PART NO.	COLOR EMITTED	INPUT VOLTAGE, V @28Vdc (typ)	CURRENT (A)	MAXIMUM CANDELA	λP nm	VIEWING ANGLE (FULL BEAM WIDTH @ 50% INTENSITY)

-PROPRIETARY-
This document contains Proprietary information of LEDTRONICS, INC. It may not be copied, used or disclosed for any purpose without the prior express written consent of LEDTRONICS, INC.

.XXX ± .010 TOLERANCE PER ANSI-Y14.5
.XX ± .025 (UNLESS OTHERWISE STATED)
ANGLES ± 0°,30'
FRACT. ± 1/32

TITLE					
PF56CX6-000X (PF56CX6-120VAC/8-B/TI)					
DWG NO	SCALE	SHEET	DATE		
PF56-120VAC-T	1:1	1 OF 1	09-13-16		
CODE IDENT NO.	DWG BY GP	CHK BY PL	QA	MFG	R&D
8Z410	09-13-16	09-15-16			