

RECOMMENDED PANEL CUTOUT
MAX. PANEL THICKNESS 1-6mm

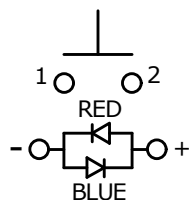

SCHEMATIC
SPST - OFF-(ON)
() DENOTES MOMENTARY

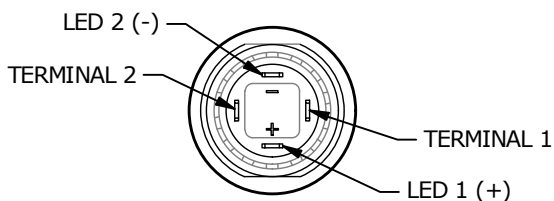
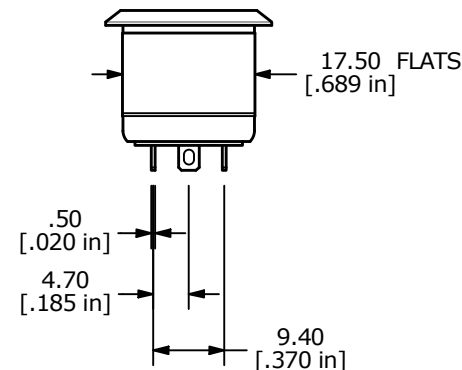
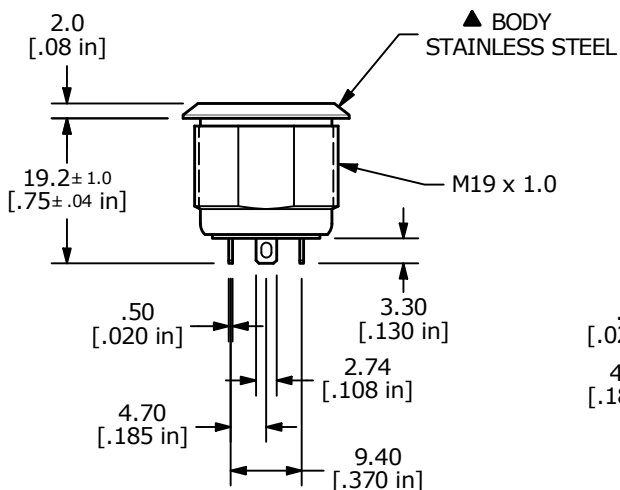
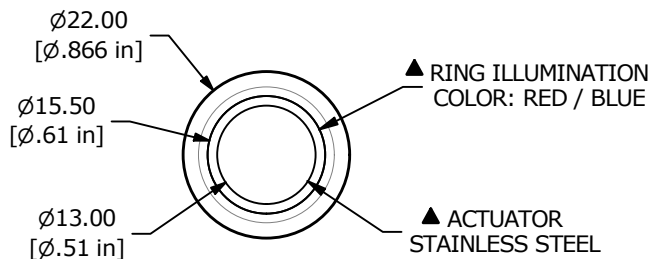

- NOTE:
1. ALL DIMENSIONS IN MM [INCH]
 2. GENERAL TOLERANCE: X.X = ±0.4
X.XX = ±0.25
 3. TERMINAL NUMBERS FOR REF ONLY
 4. CONTACT MATERIAL: SILVER
 5. RATING: 2A 36VDC
 6. ELECTRIC LIFE: 200,000 CYCLES
 7. DIELECTRIC STRENGTH: 2,000 VAC MIN. FOR 1 MINUTE
 8. CONTACT RESISTANCE: 50mΩ MAX. @ 1A 12VDC
 9. OPERATING TEMP.: -20°C to 70°C
 10. ▲ DENOTES CRITICAL PARAMETER.
 11. LAMP VOLTAGE: RED 20mA 2.0V TYP.
BLUE 20mA 3.1V TYP.
 12. TRAVEL: 1.80mm
 13. ACTUATION FORCE: 4.5 ±1.5 N
 14. MOUNTING NUT TORQUE: 1-3 Nm
 15. INGRESS PROTECTION: IP67, IK10
 16. HARDWARE SUPPLIED: O-RING and HEXNUT

REV	ECO NO	DESCRIPTION	DATE	BY
C	ECO-101692	print update	03/20/23	MW



OBJECT ID
000025966

TITLE SV4F23SS-3H1				
SCALE 1:1	DATE 6/16/2020	DR MW	DWG T840003	REV C