

DRAWING NUMBER:	1127-04M-XXXX
PRODUCT GROUP:	TERMINALS
SUB-GROUP:	MILITARY INSULATED TERMINALS
DESCRIPTION:	DIALLYL PHTHALATE INSULATED DOUBLE TURRET TERMINAL

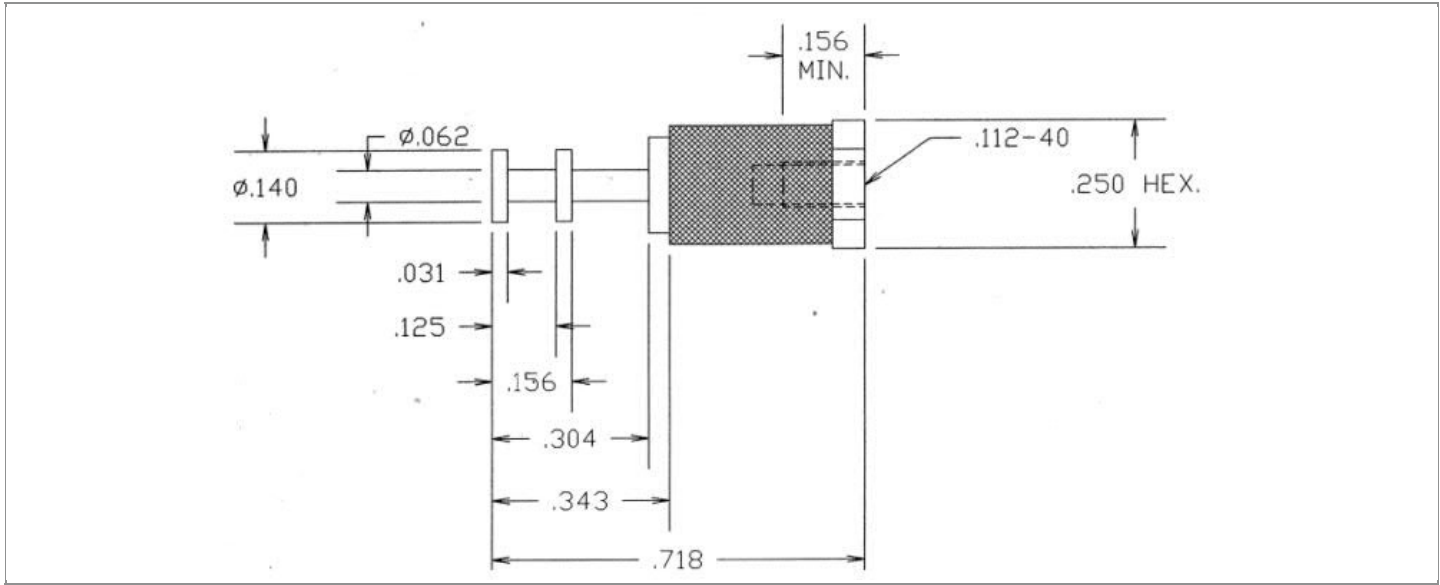

PIN DIAMETER	OVERALL LENGTH	MOUNTING ORIENTATION	BOARD / PANEL MOUNTING METHOD
N/A	0.718"	VERTICAL	THREAD MOUNT (4-40 SCREW)
BOARD / PANEL THICKNESS	MOUNTING HOLE SIZE	DRILL SIZE	FEED THRU COMBINATION
N/A	CLEARANCE FOR SCREW #4	#31	N/A

PART NO. STRUCTURE:*

1127	-	04M	-	XX	XX
PART SERIES		DIMENSION		FINISH	INSULATION COLOR

*If applicable, "Z" at the end of a PART NO. STRUCTURE indicates TERMINAL MATERIAL TYPE.

MATERIAL OPTIONS:

1127-04M-XXXX

COMPONENT	MATERIAL	MATERIAL AND SPECIFICATION
TERMINAL	BRASS	BRASS PER ASTM B16, ALLOY C36000, 1/2 HARD
BASE/METAL SLEEVE	BRASS	BRASS PER ASTM B16, ALLOY C36000, 1/2 HARD
INSULATION*	DIALLYL PHTHALATE	MOLDED DIALLYL PHTHALATE, TYPE SDG-F PER ASTM D5948
NUT	N/A	N/A
WASHER	N/A	N/A

*For Insulation color, please see INSULATION COLOR OPTIONS on Page 2

FINISH - PLATING OPTIONS:

1127-04M-XXXX

FINISH CODE	COMPONENT	FINISH	FINISH AND SPECIFICATION
05	TERMINAL	ELECTRO-SOLDER	0.000300"MIN. ELECTRO-SOLDER PER SAE-AMS-P-81728 OVER 0.000100"MIN. COPPER PER SAE-AMS-2418
	BASE/METAL SLEEVE	ELECTRO-SOLDER	0.000100"MIN. ELECTRO-SOLDER PER SAE-AMS-P-81728 OVER 0.000100"MIN. NICKEL PER SAE-AMS-QQ-N-290
	NUT	N/A	N/A
	WASHER	N/A	N/A
088	TERMINAL	BRIGHT TIN-LEAD	0.000300"MIN. BRIGHT TIN-LEAD (Sn93%-Pb7%) PER ASTM B545 OVER 0.000100"MIN. COPPER PER SAE-AMS-2418
	BASE/METAL SLEEVE	BRIGHT TIN-LEAD	0.000100"MIN. BRIGHT TIN-LEAD (Sn93%-Pb7%) PER ASTM B545 OVER 0.000100"MIN. NICKEL PER SAE-AMS-QQ-N-290
	NUT	N/A	N/A
	WASHER	N/A	N/A
095	TERMINAL	HOT SOLDER DIP	0.000100"MIN. HOT SOLDER DIP USING Sn60 PER IPC-J-STD-006 OVER 0.000100"MIN. COPPER PER SAE-AMS-2418
	BASE/METAL SLEEVE	BRIGHT TIN-LEAD	0.000100"MIN. BRIGHT TIN-LEAD (Sn93%-Pb7%) PER ASTM B545 OVER 0.000100"MIN. NICKEL PER SAE-AMS-QQ-N-290
	NUT	N/A	N/A
	WASHER	N/A	N/A

INSULATION COLOR OPTIONS:

1127-04M-XXXX

INSULATION COLOR	BLACK	BROWN	RED	ORANGE	YELLOW	GREEN	BLUE	VIOLET	GRAY	WHITE
COLOR CODE NO.	10	11	12	13	14	15	16	17	18	19

TOLERANCES:*

DECIMAL	FRACTIONAL	ANGULAR	DRAWING ORIGATION DATE	LAST MODIFICATION DATE
± 0.015	N/A	N/A	9/15/2004	3/1/2017

*All dimensions are in inches.

RoHS COMPLIANCE:

1127-04M-05XX

PART NUMBER	RoHS COMPLIANT
1127-04M-0510	NO
1127-04M-0511	NO
1127-04M-0512	NO
1127-04M-0513	NO
1127-04M-0514	NO
1127-04M-0515	NO
1127-04M-0516	NO
1127-04M-0517	NO
1127-04M-0518	NO
1127-04M-0519	NO

1127-04M-088XX

PART NUMBER	RoHS COMPLIANT
1127-04M-08810	NO
1127-04M-08811	NO
1127-04M-08812	NO
1127-04M-08813	NO
1127-04M-08814	NO
1127-04M-08815	NO
1127-04M-08816	NO
1127-04M-08817	NO
1127-04M-08818	NO
1127-04M-08819	NO

1127-04M-095XX

PART NUMBER	RoHS COMPLIANT
1127-04M-09510	NO
1127-04M-09511	NO
1127-04M-09512	NO
1127-04M-09513	NO
1127-04M-09514	NO
1127-04M-09515	NO
1127-04M-09516	NO
1127-04M-09517	NO
1127-04M-09518	NO
1127-04M-09519	NO

MILITARY REFERENCE SPECIFICATIONS:

1127-04M-05XX

PART NUMBER	MIL SPECIFICATION	MIL PART NUMBER	COMMERCIAL ITEM DESCRIPTION (CID) SPECIFICATION	CID PART NUMBER
1127-04M-0510	MIL-T-55155/20	M55155/200H01 (SE200D01S)	A-A-59126/20	AA59126/200H01
1127-04M-0511	MIL-T-55155/20	M55155/201H01 (SE201D01S)	A-A-59126/20	AA59126/201H01
1127-04M-0512	MIL-T-55155/20	M55155/202H01 (SE202D01S)	A-A-59126/20	AA59126/202H01
1127-04M-0513	MIL-T-55155/20	M55155/203H01 (SE203D01S)	A-A-59126/20	AA59126/203H01
1127-04M-0514	MIL-T-55155/20	M55155/204H01 (SE204D01S)	A-A-59126/20	AA59126/204H01
1127-04M-0515	MIL-T-55155/20	M55155/205H01 (SE205D01S)	A-A-59126/20	AA59126/205H01
1127-04M-0516	MIL-T-55155/20	M55155/206H01 (SE206D01S)	A-A-59126/20	AA59126/206H01
1127-04M-0517	MIL-T-55155/20	M55155/207H01 (SE207D01S)	A-A-59126/20	AA59126/207H01
1127-04M-0518	MIL-T-55155/20	M55155/208H01 (SE208D01S)	A-A-59126/20	AA59126/208H01
1127-04M-0519	MIL-T-55155/20	M55155/209H01 (SE209D01S)	A-A-59126/20	AA59126/209H01

1127-04M-088XX

PART NUMBER	MIL SPECIFICATION	MIL PART NUMBER	COMMERCIAL ITEM DESCRIPTION (CID) SPECIFICATION	CID PART NUMBER
1127-04M-08810	MIL-T-55155/20	M55155/200J01	A-A-59126/20	AA59126/200J01 (AA59126/20001)
1127-04M-08811	MIL-T-55155/20	M55155/201J01	A-A-59126/20	AA59126/201J01 (AA59126/20101)
1127-04M-08812	MIL-T-55155/20	M55155/202J01	A-A-59126/20	AA59126/202J01 (AA59126/20201)
1127-04M-08813	MIL-T-55155/20	M55155/203J01	A-A-59126/20	AA59126/203J01 (AA59126/20301)
1127-04M-08814	MIL-T-55155/20	M55155/204J01	A-A-59126/20	AA59126/204J01 (AA59126/20401)

Continued on next page...

MILITARY REFERENCE SPECIFICATIONS CONTINUED:

1127-04M-088XX

PART NUMBER	MIL SPECIFICATION	MIL PART NUMBER	COMMERCIAL ITEM DESCRIPTION (CID) SPECIFICATION	CID PART NUMBER
1127-04M-08815	MIL-T-55155/20	M55155/205J01	A-A-59126/20	AA59126/205J01 (AA59126/20501)
1127-04M-08816	MIL-T-55155/20	M55155/206J01	A-A-59126/20	AA59126/206J01 (AA59126/20601)
1127-04M-08817	MIL-T-55155/20	M55155/207J01	A-A-59126/20	AA59126/207J01 (AA59126/20701)
1127-04M-08818	MIL-T-55155/20	M55155/208J01	A-A-59126/20	AA59126/208J01 (AA59126/20801)
1127-04M-08819	MIL-T-55155/20	M55155/209J01	A-A-59126/20	AA59126/209J01 (AA59126/20901)

1127-04M-095XX

PART NUMBER	MIL SPECIFICATION	MIL PART NUMBER	COMMERCIAL ITEM DESCRIPTION (CID) SPECIFICATION	CID PART NUMBER
1127-04M-09510	MIL-T-55155/20	M55155/200I01	A-A-59126/20	AA59126/200I01
1127-04M-09511	MIL-T-55155/20	M55155/201I01	A-A-59126/20	AA59126/201I01
1127-04M-09512	MIL-T-55155/20	M55155/202I01	A-A-59126/20	AA59126/202I01
1127-04M-09513	MIL-T-55155/20	M55155/203I01	A-A-59126/20	AA59126/203I01
1127-04M-09514	MIL-T-55155/20	M55155/204I01	A-A-59126/20	AA59126/204I01
1127-04M-09515	MIL-T-55155/20	M55155/205I01	A-A-59126/20	AA59126/205I01
1127-04M-09516	MIL-T-55155/20	M55155/206I01	A-A-59126/20	AA59126/206I01
1127-04M-09517	MIL-T-55155/20	M55155/207I01	A-A-59126/20	AA59126/207I01
1127-04M-09518	MIL-T-55155/20	M55155/208I01	A-A-59126/20	AA59126/208I01
1127-04M-09519	MIL-T-55155/20	M55155/209I01	A-A-59126/20	AA59126/209I01

TOOLING:

INSTALLATION TOOL: ARBOR PRESS	INSTALLATION TOOL: ANVIL (ARBOR PRESS OPERATED)	INSTALLATION TOOL: PRESS-FIT / ROLL SWAGE / RIVET PUNCH (ARBOR PRESS OPERATED)	INSTALLATION TOOL: PRESS-FIT (HAND OPERATED)
N/A	N/A	N/A	N/A

NOTES:

DATASHEET NOTES

SCREW IS NOT INCLUDED.

INSTRUCTION NOTES

N/A