

## Complete units: Mushroom heads $\varnothing$ 22MM

 Technical Info (p. 103)

### ► MAINTAINED - NON-ILLUMINATED

#### $\varnothing$ 40 MUSHROOM

Push-pull to reset

Black Bezel  
Part Number

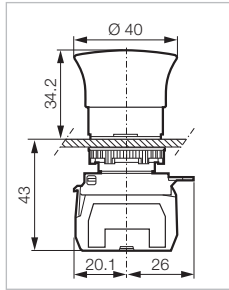

- Red NC
- Red 2 NC
- Red NO + NC

- L22DD01-3E01
- L22DD01-3E02
- L22DD01-3E11

**WITH TEXT**

- Red (STOP STOP STOP) NC
- Green NO
- Black NC
- Black NO
- Yellow NO

- L22DD01S-3E01
- L22DD02-3E10
- L22DD03-3E01
- L22DD03-3E10
- L22DD04-3E10

L22DD01-3E01

#### $\varnothing$ 32 MUSHROOM

Push-turn to reset

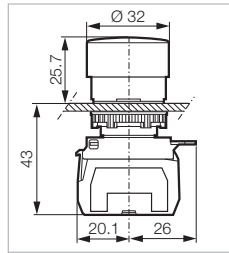

- Red NC
- Red 2 NC
- Red NO + NC

- L22EC01-3E01
- L22EC01-3E02
- L22EC01-3E11

- Green NO
- Black NC
- Black NO
- Yellow NO

- L22EC02-3E10
- L22EC03-3E01
- L22EC03-3E10
- L22EC04-3E10

L22EC01-3E01

#### $\varnothing$ 40 MUSHROOM

Push-turn to reset

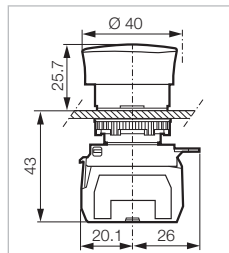

- Red NC
- Red 2 NC
- Red NO + NC

- L22ED01-3E01
- L22ED01-3E02
- L22ED01-3E11

**WITH TEXT**

- Red (STOP STOP STOP) NC
- Green NO
- Black NC
- Black NO
- Yellow NO

- L22ED01S-3E01
- L22ED02-3E10
- L22ED03-3E01
- L22ED03-3E10
- L22ED04-3E10

L22ED01-3E11

#### $\varnothing$ 40 MUSHROOM

Key to reset

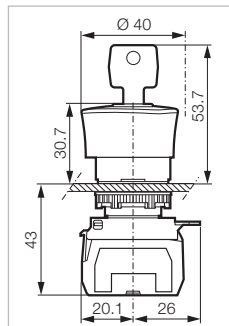

Supplied with 2 keys profile n°455

- Red NC
- Red 2 NC
- Red NO + NC

- L22GM01-3E01
- L22GM01-3E02
- L22GM01-3E11

L22GM01-3E01